

Kansas City Metro Office
1290 S. Enterprise
Olathe, KS 66061-5355



phone: 913-942-3100
fax: 913-782-5914
www.ksdot.org

Julie Lorenz, Secretary

Laura Kelly, Governor

IMMEDIATE RELEASE
July 2, 2020

For more information:

Kelly Kultala
(785) 207-0715
Kelly.Kultala@ks.gov

Bridge joint replacement on I-635 in Wyandotte County begins July 6

A bridge joint replacement project on I-635, in Wyandotte County, to begin at 7 p.m., Monday, July 6, weather permitting. The bridge is located over the Burlington Northern Santa Fe railyard located between Kansas Avenue and Swartz Road in Kansas City.

Regular work hours will be 7 a.m. to 3:30 p.m., Monday to Friday, and Saturdays, as needed. Project is expected to be completed in late November.

Drivers will be restricted to two lanes northbound and southbound, and lane width will be restricted to 11 to 12 feet. Traffic will be controlled using signage, detour signage and traffic cones.

The exit ramp from northbound I-635 to K-32/Kansas Avenue and the on ramp from K-32/Kansas Avenue to southbound I-635 will be closed for the duration of the project. See map below for alternative detour routes.

Superior Bowen Asphalt Co. of Kansas City, Mo is the contractor and Comanche Construction of Olathe is the subcontractor on the \$1.7 million project.

KDOT urges all motorists to be alert and obey the warning signs when approaching and driving through a highway work zone. To stay aware of all road construction projects across Kansas go to www.kandrive.org or call 5-1-1. Drive safely and always wear your seat belt.

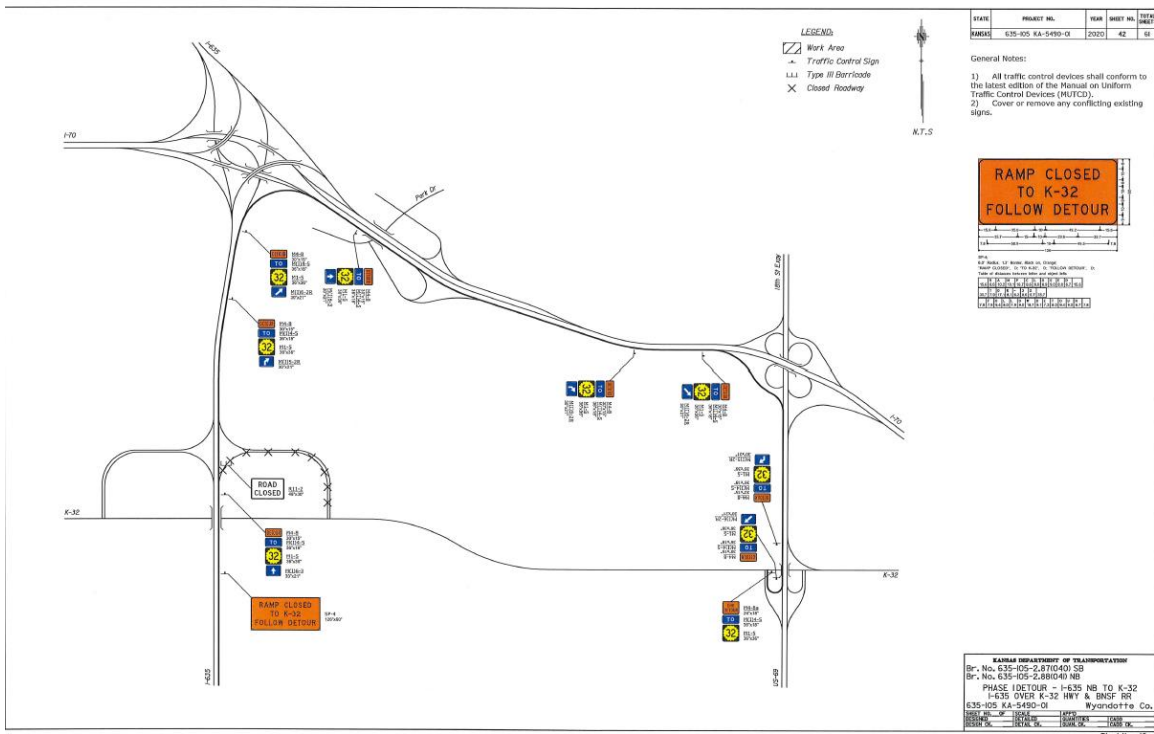
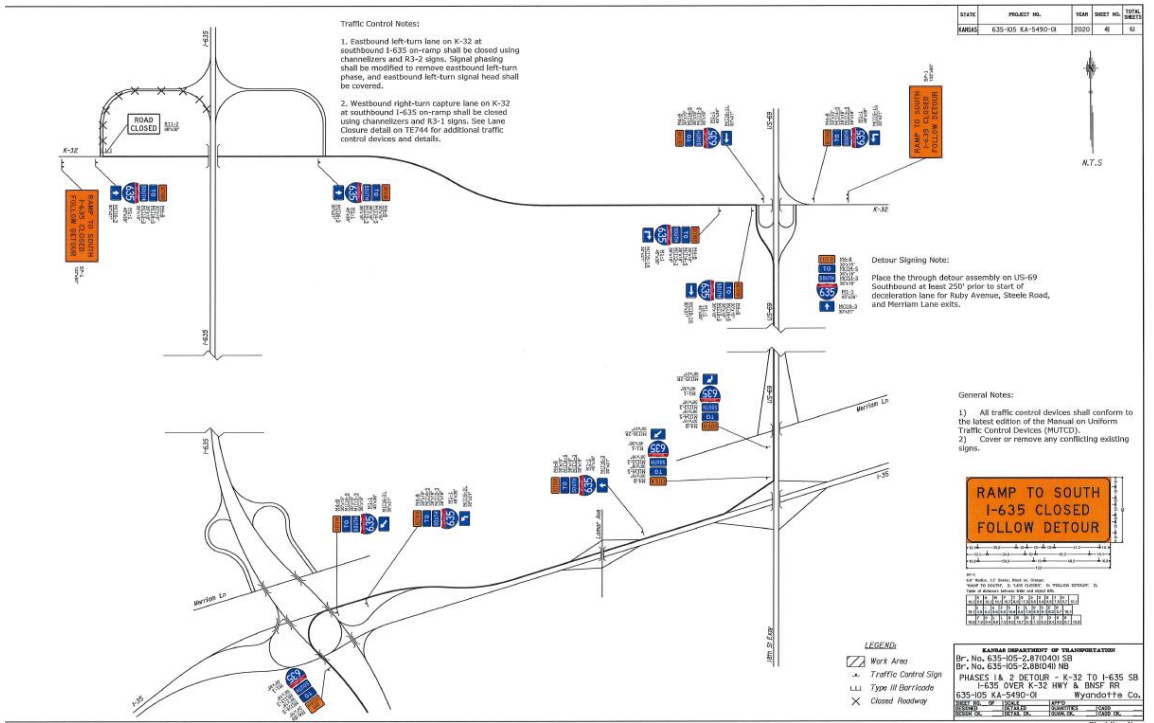

###

This information can be made available in alternative accessible formats upon request.

For information about obtaining an alternative format, contact the KDOT Office of Public Affairs,
700 SW Harrison St., 2nd Fl West, Topeka, KS 66603-3754 or phone 785-296-3585
(Voice)/Hearing Impaired – 711.

Click below to connect to KDOT's Social Networks:

