

## NEWS RELEASE

August 31, 2007

07-305

**FOR IMMEDIATE RELEASE**

News Contact: Kimberly Qualls, (785) 296-3881 or [kqualls@ksdot.org](mailto:kqualls@ksdot.org)  
Burt Morey, (913) 764-4525 or [bmorey@ksdot.org](mailto:bmorey@ksdot.org)

### **Median Changes Scheduled for K-7 & 75th Street Interchange in Johnson County**

The Kansas Department of Transportation (KDOT), in conjunction with the City of Shawnee and the De Soto School District, reviewed options for potential median modifications at the intersection of K-7 and 75th Street to address potential safety concerns. KDOT staff recently conducted a traffic study to evaluate traffic flow and safety issues at this intersection. The traffic study concluded that if and when changes needed to be made at the intersection that median modifications were the recommended option to ensure a continued safe level of service for the traveling public.

Based on the new development and continued growth along both sides of K-7, and the fact that the De Soto School District is divided by K-7, KDOT staff has decided to move forward with the implementation of these modifications. The modifications are being made to provide additional safety by lessening the possibility of crashes between K-7 and 75th Street traffic. Both the City of Shawnee and the De Soto School District support this plan of action.

The median modifications to be implemented will affect traffic movements for 75th Street traffic only. Traffic on 75th Street will be allowed to only make right turns onto K-7. Traffic turning left from K-7 will be directed onto 75th Street via the installation of flexible tubular markers and plastic curbs in the median of K-7. Traffic on 75th Street will be directed to make right turns only with the addition of right turn only signage and pavement markings on both the east and west side of K-7. See the attached document for a visual layout depicting the complete median modifications.

Weather permitting, by Friday, September 14, the installation for the tubular markers and curbs in the median on K-7 are scheduled to be completed. Approximately one week prior to completion of

the work for these median modifications, electronic message boards will be placed along 75th Street to inform drivers of the upcoming changes.

The additional right-turn only signage and pavement markings at 75th Street for both the east and west side of K-7 are scheduled to be completed by early October 2007.

For more information on this median modification project, please contact Kimberly Qualls, Northeast Kansas Public Affairs Manager, at (785) 296-3881 or Burt Morey, Metro Engineer - Olathe, at (913) 764-4525.

###

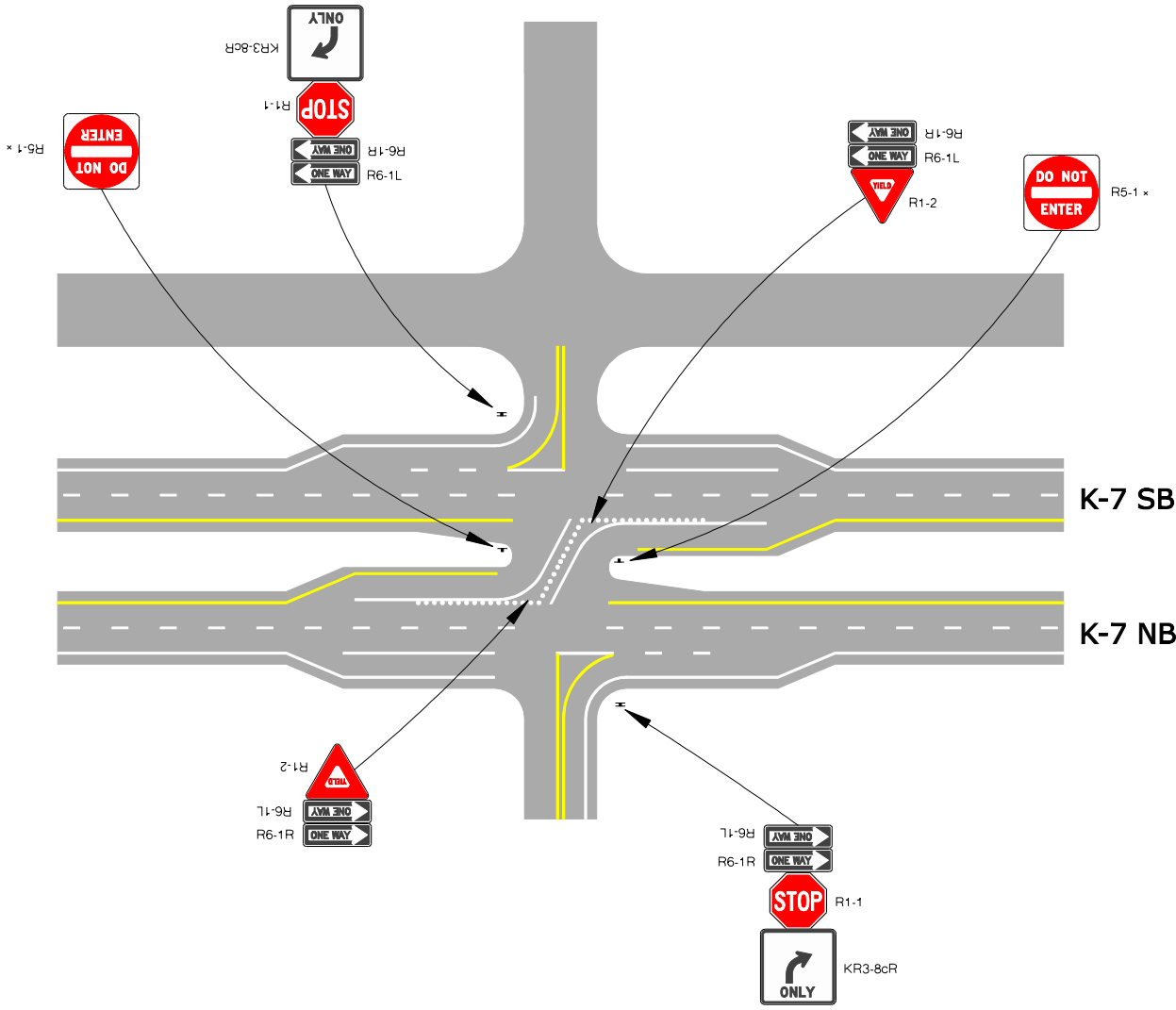

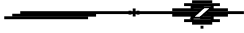
  
**K-7 & 75th St**  
 City of Shawnee  
 Johnson County

\* R5-1 signs are optional