

South Central District Office
500 N. Hendricks
Hutchinson, KS 67504-0769



phone: 620-663-3361
fax: 620-663-1804
www.ksdot.org

Julie Lorenz, Secretary

Laura Kelly, Governor

IMMEDIATE RELEASE

April 28, 2021

For more information: Tim Potter

620-860-7389; mobile: 620-727-2278; Tim.Potter@ks.gov

Field survey for K-11 bridge replacement in Kingman County

A field survey for a proposed bridge replacement on K-11 in Kingman County will start around Monday, May 10.

The proposed bridge replacement is on K-11 over Smoots Creek, 5.7 miles north of the U.S. 54 junction. The approximate length of the survey is 3,000 feet. The survey is based on existing alignment.

The field survey – estimated to be completed by July 1 -- will gather information needed for detailed design of the proposed improvement.

A member of the survey crew first will contact property owners and/or tenants for permission to enter private property. Survey activities will include the use of survey instruments on the ground to determine locations of existing features within the survey corridor.

John Lilak, P.S., Survey Project Manager, Bartlett West, will be in charge of the survey for the Kansas Department of Transportation.

The map below shows the survey location, marked with the red arrow.

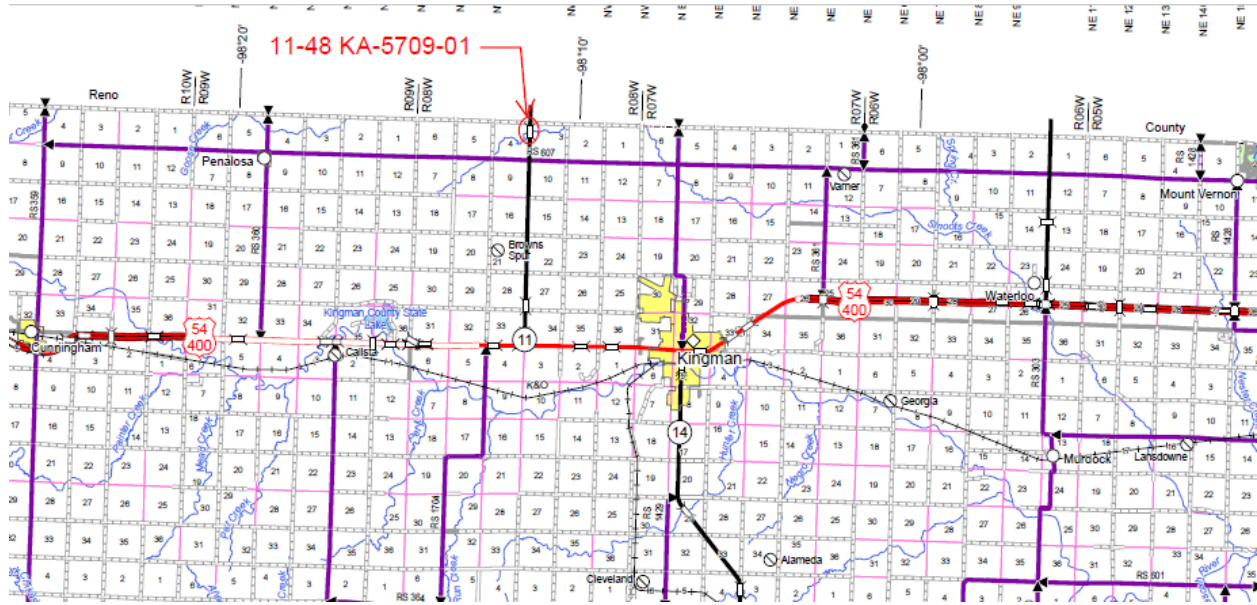

####

This information can be made available in alternative accessible formats upon request.

For information about obtaining an alternative format, contact the KDOT Division of Communications,
 700 SW Harrison St., 2nd Fl West, Topeka, KS 66603-3754 or phone 785-296-3585 (Voice)/Hearing Impaired – 711.

Click below to connect to KDOT's Social Networks:

