

South Central District Office
500 N. Hendricks
Hutchinson, KS 67504-0769



phone: 620-663-3361
fax: 620-663-1804
www.ksdot.org

Julie Lorenz, Secretary

Laura Kelly, Governor

IMMEDIATE RELEASE

Jan. 19, 2021

For more information: Tim Potter

620-860-7389; mobile: 620-727-2278; Tim.Potter@ks.gov

Survey for U.S. 56 bridge in Rice County set to begin around Jan. 25

A field survey for a proposed replacement bridge on U.S 56 in Rice County is scheduled to begin around Jan. 25.

The proposed replacement is over Spring Creek drainage 6.85 miles east of the Barton County line.

The approximate length of survey is 2,000 feet. The survey is based on existing alignment.

The survey is needed for the detailed design of the proposed improvement and is estimated to be completed by April 1.

A member of the survey crew first will contact property owners and/or tenants for permission to enter private property. Survey activities will include use of survey instruments on the ground to determine locations of existing features within the survey corridor.

Jim Nider, P.S., Survey Project Manager, SMH, will be in charge of this survey for the Kansas Department of Transportation.

A red arrow on the county map below points to the project location.

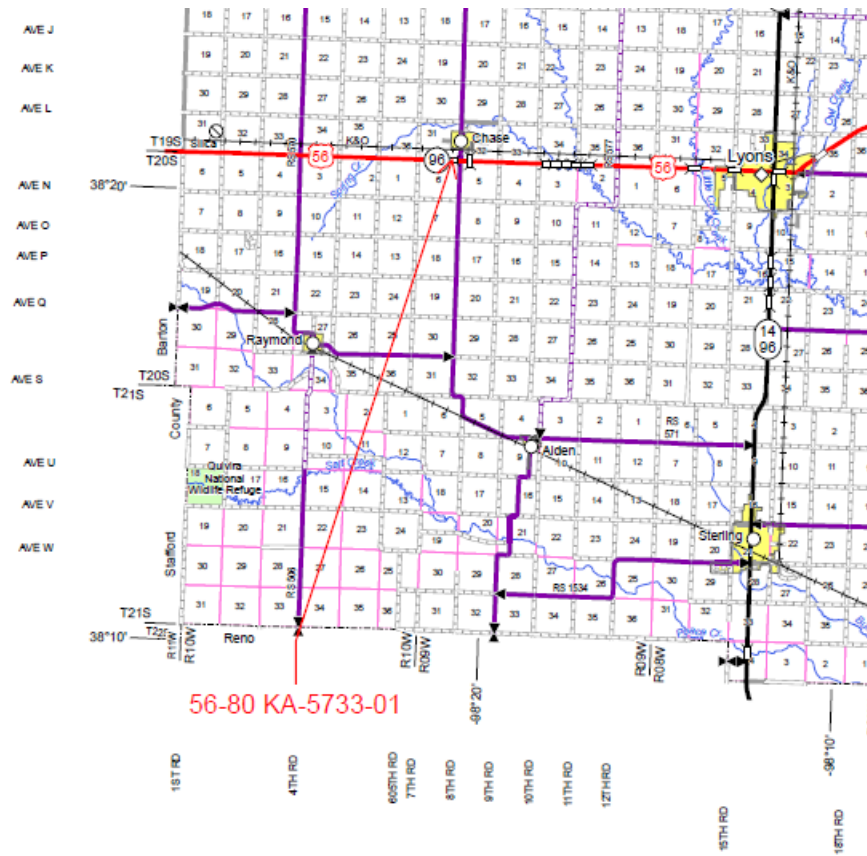

####

This information can be made available in alternative accessible formats upon request.

For information about obtaining an alternative format, contact the KDOT Division of Communications, 700 SW Harrison St., 2nd Fl West, Topeka, KS 66603-3754 or phone 785-296-3585 (Voice)/Hearing Impaired – 711.

Click below to connect to KDOT's Social Networks:

