

ROADS AND ROADWAY FEATURES	
Controlled Access (With Interchange) - Interstate	[Symbol]
Kansas Turnpike (KTA) (With Interchange)	[Symbol]
US Route - Controlled Access (With Interchange)	[Symbol]
US Route - Divided	[Symbol]
US Route - Undivided	[Symbol]
State Route - Controlled Access (With Interchange)	[Symbol]
State Route - Divided	[Symbol]
State Route - Undivided	[Symbol]
RS Route - Divided	[Symbol]
RS Route - Paved	[Symbol]
RS Route - Unpaved	[Symbol]
Minor Road - Paved	[Symbol]
Minor Road - Stone or Gravel	[Symbol]
Minor Road - Soil	[Symbol]
Side Road or Street in Unincorporated Area	[Symbol]
Rural Secondary System	[Symbol]
County Road System	[Symbol]
Points Between Which Distances are Measured	[Symbol]
Interstate Numbered Highway	[Symbol]
U.S. Numbered Highway	[Symbol]
State Highway System or State Numbered Highway	[Symbol]
End of Designated System or Marked Route	[Symbol]
Kansas Turnpike Authority	[Symbol]
Railroad (Operating Company)	[Symbol]
Grade Crossing	[Symbol]
Railroad Above	[Symbol]
Railroad Below	[Symbol]
Airways and Airports	[Symbol]
Military Field (Some Facilities Available)	[Symbol]
Airfield (Limited Facilities)	[Symbol]
Airway Light Beacon (General)	[Symbol]
Airport (Complete Facilities) (Commercial or Municipal)	[Symbol]
Drainage	[Symbol]
Major River	[Symbol]
River	[Symbol]
Major Drainage	[Symbol]
Minor Drainage	[Symbol]
Irrigation Ditch or Canal	[Symbol]
Lake Subject to Flood, Overflow Land	[Symbol]
Lake, Reservoir, or Pond (With Dam)	[Symbol]
Bridges	[Symbol]
Bridges (Total Span Greater than 20 Feet)	[Symbol]
Open to Traffic	[Symbol]
Closed to Traffic	[Symbol]
Twin Bridges	[Symbol]
Highway Grade Separation	[Symbol]
Miscellaneous	[Symbol]
Roundabout	[Symbol]
Bike and Walking Trail	[Symbol]
Levee or Dike	[Symbol]
Natural or Concrete Field	[Symbol]
Gate Across Any Road (Any Type)	[Symbol]
Boundaries	[Symbol]
State	[Symbol]
County	[Symbol]
City Limits	[Symbol]
Section Lines	[Symbol]
Boundary to Mark Enlargement Inset	[Symbol]
Parks and Other Reservations National, State, County or Municipal Park, Indian Reservation, National Monument, Federal Development Project	[Symbol]
Urban Boundary	[Symbol]
Conservation and Recreation	[Symbol]
Public Recreation	[Symbol]
Scenic, Tourist, or Historical Site	[Symbol]
Trailer Park	[Symbol]
Hotel or Motel	[Symbol]
Camp or Lodge (Permanent Site with Building)	[Symbol]
Small Park (SP - State Park, CP - County Park, MP - Municipal Park, SR - Safety Rest Area)	[Symbol]
Fish Hatchery	[Symbol]
Game Farm	[Symbol]
Game Preserve or Bird Sanctuary	[Symbol]
Rifle Club (Public)	[Symbol]
Golf Course or Country Club	[Symbol]
Riding Academy, Saddle Club, or Stables	[Symbol]
Race Course or Speedway	[Symbol]
Marina	[Symbol]
Rodde Grounds	[Symbol]
Fair Grounds	[Symbol]
Farm Units, Dwellings, Etc.	[Symbol]
Dwelling	[Symbol]
Multi Dwelling	[Symbol]
Church or Other Religious Institution	[Symbol]
Cemetery	[Symbol]
Church with Cemetery	[Symbol]
Rest Home	[Symbol]
Hospital	[Symbol]
State Port of Entry or Weigh Station	[Symbol]
Group of Mixed Cultural Features Closely Spaced	[Symbol]
Industrial	[Symbol]
Store or Small Business Establishment	[Symbol]
Mine	[Symbol]
Oil or Gas Well(s)	[Symbol]
Storage Tank(s) (Gas or Oil)	[Symbol]
Pumping or Gauging Station	[Symbol]
Orchard or Tree Farm	[Symbol]
Grain Elevator	[Symbol]
Stock Yard - Loading Pen or Corral	[Symbol]
Quarry	[Symbol]
Fuel Oil	[Symbol]
Educational and Correctional Institution	[Symbol]
Schoolhouse	[Symbol]
Grange, Townhall, or Community Center	[Symbol]
K.S.U. Agricultural Research Center	[Symbol]
Correctional Institution	[Symbol]
Museum (General)	[Symbol]
Public Library	[Symbol]
Public Service Facilities	[Symbol]
Post Office	[Symbol]
Road Maintenance Shop	[Symbol]
Fire Station	[Symbol]
Landfill	[Symbol]
Sewage Disposal Plant	[Symbol]
Salvage Yard	[Symbol]
Power Plant	[Symbol]
Power Substation	[Symbol]
Water Tower	[Symbol]
Water Treatment Plant	[Symbol]
Wind Farm	[Symbol]
Radio Station (With Call Letters)	[Symbol]
U.S. Corps of Engineers Office	[Symbol]
Natural Features	[Symbol]
Prominent Elevation - With Name (Numerals Indicate Elevation Above Sea Level)	[Symbol]
500	[Symbol]
Military	[Symbol]
Fort, Army Camp, Barracks, or Other Military Post	[Symbol]
FORT RILEY	[Symbol]
Cities or Named Places	[Symbol]
State Capital	[Symbol]
County Seat	[Symbol]
Proposed Place	[Symbol]
Locale	[Symbol]
Incorporated City	[Symbol]

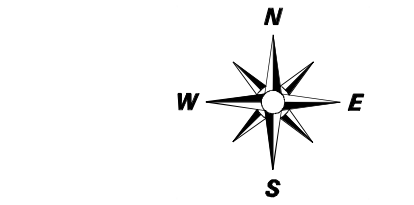
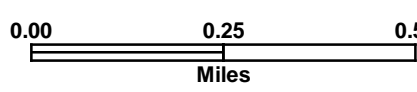
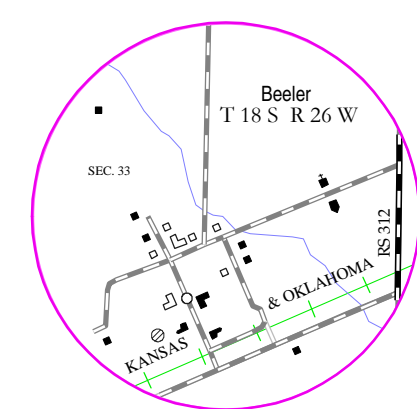
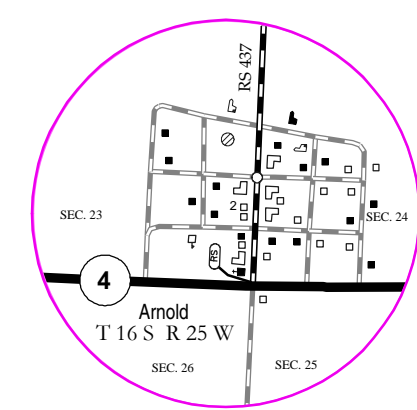

GENERAL HIGHWAY MAP
NESS COUNTY
KANSAS

PREPARED BY THE

KANSAS DEPARTMENT OF TRANSPORTATION
BUREAU OF TRANSPORTATION PLANNING
 IN COOPERATION WITH
U.S. DEPARTMENT OF TRANSPORTATION
FEDERAL HIGHWAY ADMINISTRATION

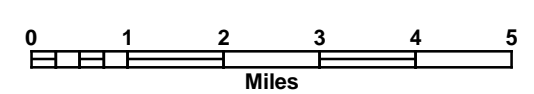

DECEMBER 2009
 LAMBERT CONFORMAL CONIC PROJECTION

POPULATION - 2000 U.S. CENSUS
 JULY 1, 2007 ESTIMATES AS
 CERTIFIED TO THE SECRETARY OF STATE
 BY DIVISION OF THE BUDGET JULY 1, 2008
 REINVENTORY COMPLETED 06-0-2008
 RURAL SECONDARY
 SYSTEMS REVISED TO 11-04-2003
 STATE BRIDGE DATA
 REVISED TO 10-26-2008
 NON-SYS BRIDGE DATA
 REVISED TO 10-08-2008

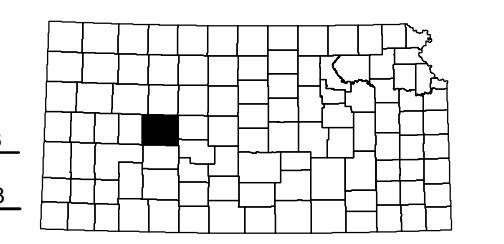

KDOT makes no warranties, guarantees, or
 representations for accuracy of this information and
 assumes no liability for errors or omissions.

**COMPUTER
 GENERATED**