

### LEGEND

ROADS AND ROADWAY FEATURES	CONSERVATION AND RECREATION
Primitive Road (Type A)	Picnic Ground
Unimproved Road (Type B)	Playground, Ball Field, Etc.
Graded and Drained Road (Type C)	Bathing Beach or Swimming Pool
Soil Surfaced Road (Type D)	Scenic Site
Gravel or Stone Road	Camp Site, No Permanence (Tents or Trailer Parking)
Not Graded or Drained (Type E-1)	Tourist Court or Motel (Figure Indicates Number of Permanent Cabins or Cottages)
Gravel or Stone Road	Camp or Lodge (Permanent Site With Building)
Graded and Drained (Type E-2)	Small Park (SP-State CP-County)
Stabilized Surface (Type E-3)	MP-Municipal, SR-Safety, Rest Areas
Bituminous Road-Low Type (Type F, G, H, I, J, K, L)	Fish Hatchery
Paved Road (Type D, H, J, K, L)	3rd Sanctuary
Divided Highway	Game Farm
Highway With Full Control of Access	Game Preserve
Side Roads and Streets in Unincorporated Urban Composts and Extensions of Local Roads Within Municipalities	Rifle Club
4 Lane Undivided Highway	Golf Ground or Country Club
Projected Road	Riding Academy
	Yacht Club
	Amusement Park or Hot
	Fair Ground, Race Course, Speedway
	Drive-In Theatre
	Marina
	Rodeo Grounds
	Guide House or Gate House (Add Letters N or S to Indicate National or State Park)
	FARM UNITS, DWELLINGS, ETC.
	Farm Unit
	Dwelling (Other Than Farm)
	Row or Group of Dwellings Closely Spaced (Figure Denotes Number of Dwellings)
	Dwelling and Filing Station
	Dwelling, Business and Filing Station
	Dwelling, Business and Filing Station
	Seasonal or Summer Colony Dwelling
	Hotel
	Humane Society Quarters
	Church or Other Religious Institution
	Church and School (Unit Used)
	Cemetery
	Church With Cemetery Adjacent
	Fresh Air Farm or Rest Home
	Hospital
	Well
	State Post of Entry or Weight Station
	Group of Mixed Cultural Features Closely Spaced (Figure above bar indicates number of dwellings included in the group; Figures over individual units show number of each included regardless of order)
	Store or Small Business Establishment
	Business and Post Office
	Business and Filing Station
	Business, Filing Station, and Post Office
	Factory and Industrial Plant
	Mine Shaft or Drift (Any Kind)
	Oil or Gas Well
	Oil or Gas Field
	Storage Tank (Gas or Oil) (Figure Denotes Number of Tanks)
	Filling Station (Not Connected With Other Business)
	Pumping Station (Oil or Gas)
	Gauging or Pumping Station (General)
	Valve House
	Seasonal Industry (Cannery or Small Grain Mill)
	Milk Depot, Creamery or Cheese Factory
	Fruit or Produce Packing House
	Road Stand Farm Products Sales
	Warehouse-General (If Government Add State or U.S.)
	Grain Elevator
	Group of Grain Storage Bins
	Dormitory
	Nursery
	Stock Yard-Loading Pen or Corral
	Stock Pen at Railroad Station (Small)
	Gravel Pit
	Quarry
	Kim or Oven (Lime, Clay Products, Coke, Etc.)
	Feed Lot
	Shopping Center
	Seasonal Business
	Sawmill (Stationary)
	EDUCATIONAL AND CORRECTIONAL INSTITUTIONS
	School
	Consolidated or Large School
	Tenants' Garage or Community Hall
	Agricultural Experiment Station
	Correctional Institution
	Museum-General
	Public Library
	PUBLIC SERVICE FACILITIES
	Post Office
	Highway Garage
	Fire Engine House
	Garbage or Rubbish Dump
	Sanitary Landfill
	Auto Salvage Yard
	Transformer Station
	Power Plant
	Power Substation
	Booster Station
	Water Supply Stand Pipe or Tank
	Radio Station (With Call Letters)
	Radio Range Station
	Water Treatment Plant
	Jury Room
	U. S. Corps of Engineers Office
	MISCELLANEOUS
	Fort, Army Camp, Barracks or Other Military Post
	Transportation Station
	Bench Mark (With Elevation)

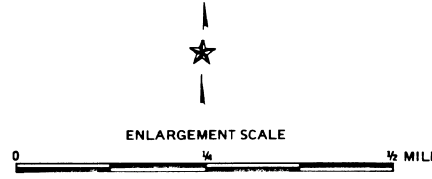
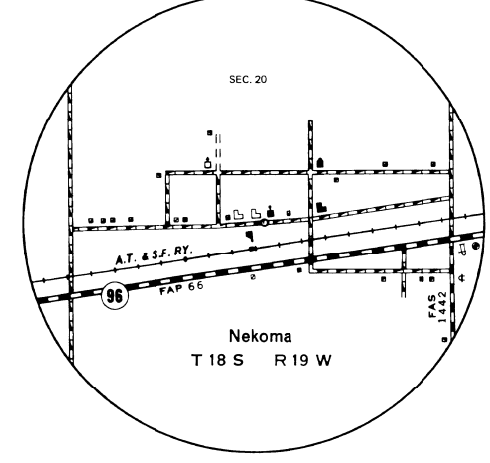

# GENERAL HIGHWAY MAP RUSH COUNTY KANSAS

PREPARED BY THE  
KANSAS DEPARTMENT OF TRANSPORTATION  
BUREAU OF TRANSPORTATION PLANNING  
IN COOPERATION WITH THE  
U. S. DEPARTMENT OF TRANSPORTATION  
FEDERAL HIGHWAY ADMINISTRATION

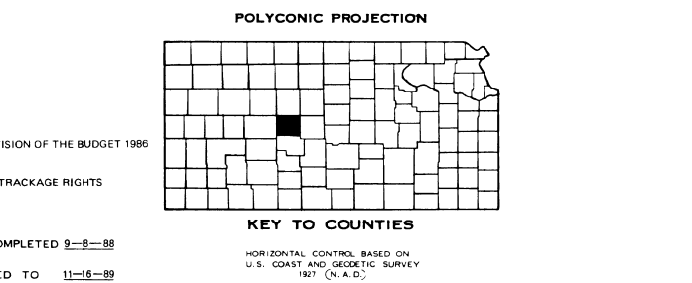

POPULATIONS - DIVISION OF THE BUDGET 1980  
THE D.A.R.M. HAS TRACKAGE RIGHTS ON THE U.S.S.  
RECONSTRUCTION COMPLETED BY F.A. AND STATE SYSTEMS REVISED TO