

**LEGEND**

ROADS AND ROADWAY FEATURES		CONSERVATION AND RECREATION	
Primitive Road (Type A)	-----	Picnic Ground	△
Unimproved Road (Type B)	-----	Playground, Ball Field, Etc.	△
Graded and Drained Road (Type C)	-----	Beating Beach or Swimming Pool	△
Soil Surfaced Road (Type D)	-----	Boat Ramp	△
Gravel or Stone Road - Not Graded or Drained (Type E-1)	-----	Boat Dock	△
Gravel or Stone Road - Graded and Drained (Type E-2)	-----	Camp Site (No Permanent Tents or Trailer Parking)	△
Gravel or Stone Road With Stabilized Surface (Type E-3)	-----	Tourist Court or Motel (Figure Indicates Number of Permanent Cabins or Cottages)	△
Illuminated Road - Low Type (Type F, G-1, H-1)	-----	Camp or Lodge (Permanent Site with Building)	△
Paved Road (Type G-2, H-2, I, J, K, L)	-----	Small Park (50-Acre, 200-Acre)	△
Divided Highway	=====	Municipal, State, or Federal Area	△
Highway With Full Control of Access	=====	Fish Hatchery	△
Side Roads and Streets in Unincorporated Urban Compacts and Extensions of Local Roads Within Municipalities	-----	Wild Sanctuary	△
4 Lane Undivided Highway	=====	Game Preserve	△
Projected Road	-----	Rifle Club	△
Road System Designation	-----	Ball Ground or Country Club	△
Federal-Aid Interstate Highway System	=====	Riding Academy	△
Federal-Aid Primary Highway System	=====	Yacht Club	△
Federal-Aid Secondary Highway System	=====	Amusement Park or Hall	△
Federal-Aid Urban Highway System	=====	Fair Ground, Race Course, Speedway	△
Points Between Which Distances are Measured	-----	Drive-In Theatre	△
Interstate Numbered Highway	=====	Marina	△
U.S. Numbered Highway	=====	Roadside Gravel	△
State Highway System or State Numbered Highway	=====	Guide House or Gate House (Add Letters N or S to indicate National or State Park)	△
End of Designated System or Marked Route	-----	FARM UNITS, DWELLING, ETC.	
		Dwelling	△
		Multi-Dwelling	△
		Combined Dwelling and Store	△
		Dwelling and Post Office	△
		Dwelling and Filling Station	△
		Dwelling, Business and Filling Station	△
		Tenant House	△
		Host Inn	△
		Homeless Society Quarters	△
		Church or Other Religious Institution	△
		Church (Not Religious Institution)	△
		Cemetery	△
		Church With Cemetery, Adjoining	△
		Fresh Air Farm or Rest Home	△
		Hospital	△
		Water Well	△
		State Port or Entry or Weight Station	△
		Group of Open Cultural Features Closely Spaced (Figure above bar indicates number of dwellings included in the group; figure over individual units show number of each included regardless of order)	△
		INDUSTRIAL	
		Store or Small Business Establishment	△
		Business and Post Office	△
		Business and Filling Station	△
		Business, Filling Station, and Post Office	△
		Factory or Industrial Plant	△
		Mineral Plant or Quarry (Any Kind)	△
		Oil or Gas Well	△
		Oil or Gas Field	△
		Storage Tank (Gas or Oil, Figure denotes Number of Tanks)	△
		Filling Station (Not Connected with Other Business)	△
		Pumping Station (Oil or Gas)	△
		Gasping or Pumping Station (General)	△
		Valve House	△
		Refrigeration Industry (Cannery or Small Grain Mill)	△
		Milk Depot Creamery or Cheese Factory	△
		Fruit or Nut Orchard	△
		Fruit or Produce Packing House	△
		Road Stand Farm, Produce Sales	△
		Warehouse - General (If Government Add State or U.S.)	△
		Group of Grain Storage Bins	△
		Greenhouse	△
		Nursery	△
		Stock Yards (Loading Pen or Corral)	△
		Stock Pen at Railroad Siding (Small)	△
		Sand Drive Pit	△
		Rock Quarry	△
		Kiln or Oven (Lime, Clay, Products, Coke, Etc.)	△
		Feed Lot	△
		Shopping Center	△
		Seasonal Business	△
		Sawmill (Stationary)	△
		EDUCATIONAL AND CORRECTIONAL INSTITUTION	
		Schoolhouse	△
		Consolidated or Large School	△
		College, Township or Community Hall	△
		Agricultural Experiment Station	△
		Correctional Institution	△
		Museum - General	△
		Public Library	△
		PUBLIC SERVICE FACILITIES	
		Post Office	△
		Highway Garage	△
		Fire Engine House	△
		Garage or Rubbish Dump	△
		Sanitary Disposal Plant	△
		Auto Salvage Yard	△
		Transformer Station	△
		Power Plant	△
		Power Substation	△
		Booster Station	△
		Water Supply Stand Pipe or Tank	△
		Radio Station (With Call Letters)	△
		Radio Range Station	△
		Water Treatment Plant	△
		Junkyard	△
		U.S. Corps of Engineers Office	△
		MISCELLANEOUS	
		Fort, Army Camp, Barracks or Other Military Post	△
		Transpension Station	△

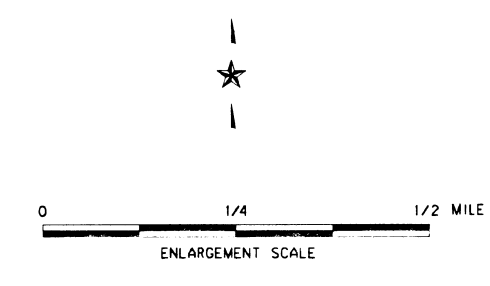
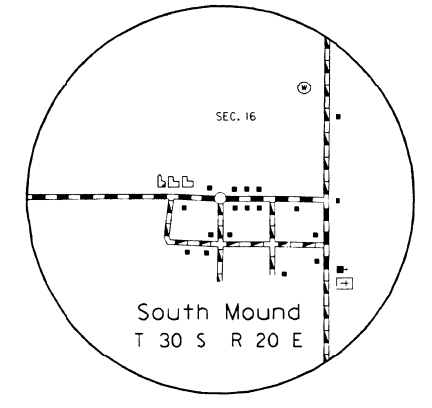
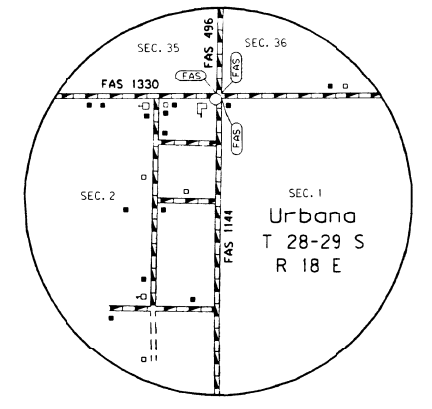
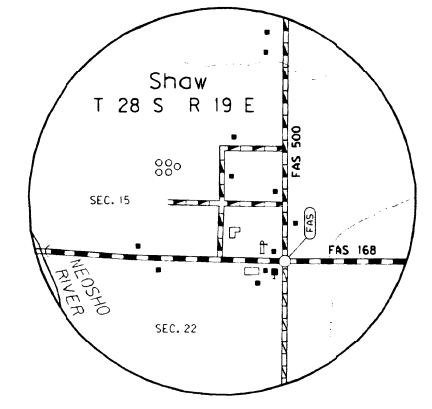
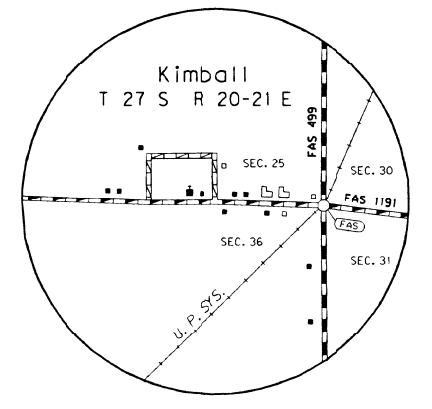
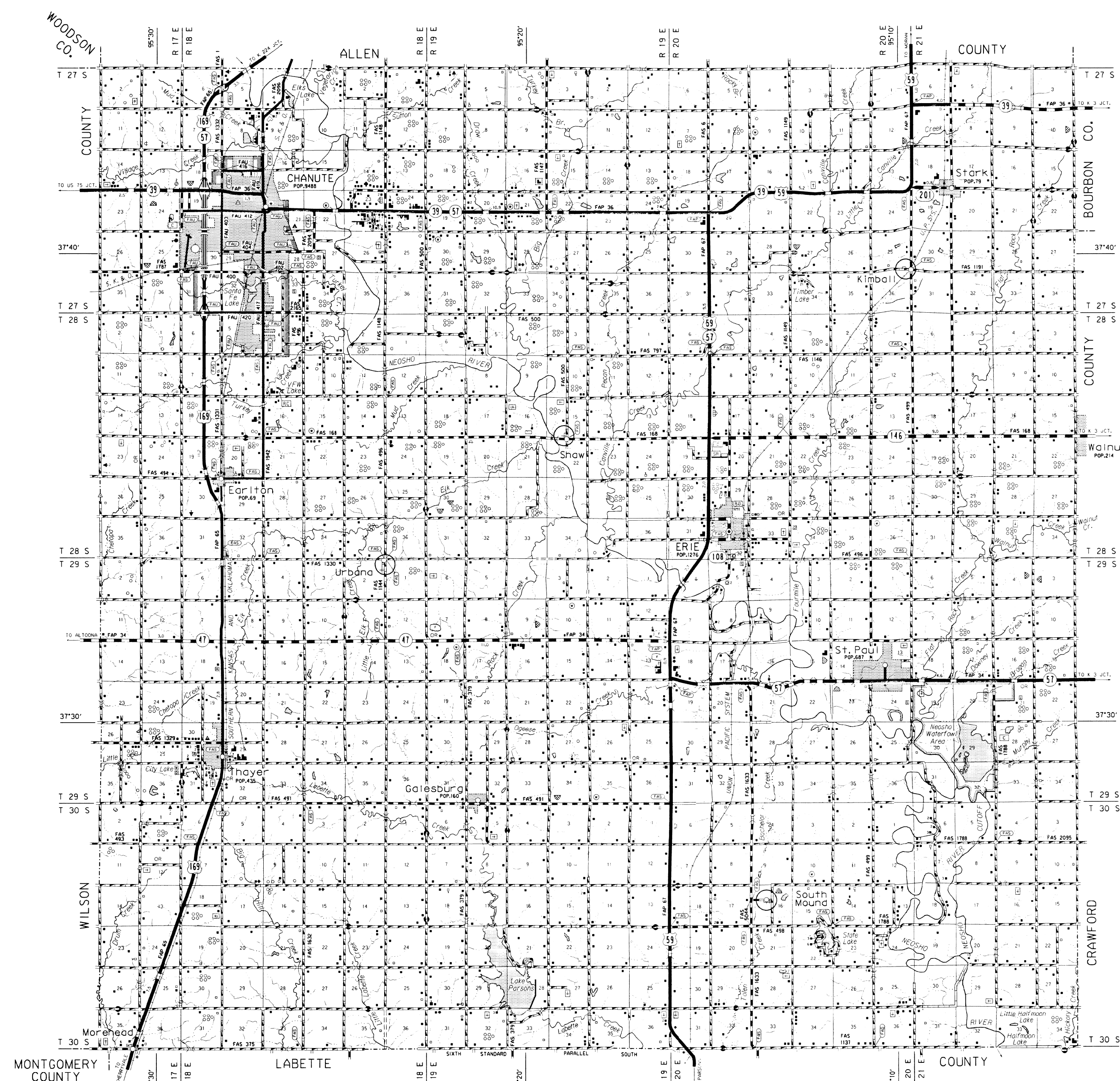

**GENERAL HIGHWAY MAP  
NEOSHO COUNTY  
KANSAS**

PREPARED BY THE  
KANSAS DEPARTMENT OF TRANSPORTATION  
BUREAU OF TRANSPORTATION PLANNING  
IN COOPERATION WITH THE  
U.S. DEPARTMENT OF TRANSPORTATION  
FEDERAL HIGHWAY ADMINISTRATION

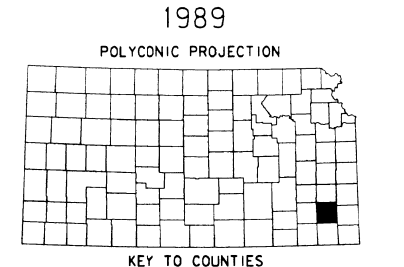
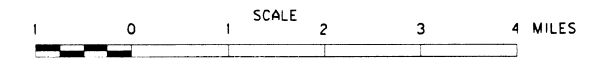

POPULATION - 1990 U.S. CENSUS  
INVENTORY COMPLETED 3-8-89  
P.L. AND STATE SYSTEMS REVISED TO 8-6-89

COMPUTER GENERATED