

**KANSAS DEPARTMENT OF TRANSPORTATION
SPECIAL PROVISION TO THE
STANDARD SPECIFICATIONS, EDITION 2007**

Add a new SECTION to DIVISION 800.

**WORK ZONE TRAFFIC CONTROL AND SAFETY
(MOBILE OPERATIONS) (PAVEMENT MARKING)
ON MULTI-LANE HIGHWAY**

Use these traffic control plans with mobile pavement marking operations that do not require the workers (Contractor or KDOT) to be on the roadway outside their vehicle.

Provide all required traffic control signs and devices and vehicles.

The Engineer will not measure the signs, devices, and vehicles (used for mobile operations) for payment. These items are subsidiary to the contract Traffic Control items.

- Equip the striping vehicle with high-intensity rotating, flashing, oscillating, or strobe lights. Equip the rear shadow vehicle with 2 high-intensity flashing lights mounted on the rear adjacent to the “CAUTION WET PAINT” sign. Equip all vehicles so that they display the high-intensity rotating, flashing, oscillating, or strobe lights both forward and to the rear.
- Equip the rear shadow vehicle with a Truck Mounted Attenuator (TMA) and an arrow display.
- The Engineer may require additional shadow vehicles with arrow panels to warn traffic of the striping operation.
- Mount the vehicle-mounted signs so that the bottom of the sign is a minimum of 1 foot above the pavement. Cover the sign legends (or turn from view) when work is not in progress. Place signs on shadow vehicles so that they do not obscure flashing or sequencing arrow panel.
- Vary the distance between the striping vehicle and the shadow vehicles according to terrain, paint drying time (edgeline only), and sight distance. Whenever adequate stopping sight distance exists to the rear, have the rear shadow vehicle maintain a minimum distance and proceed at the same speed as the striping vehicle. Have the rear shadow vehicle slow down in advance of vertical or horizontal curves that restrict sight distance.
- Installing edgelines by mobile operation may be allowed with Engineer approval.
- Do not install skip lines under mobile operation.

02-01-10 TST (BH)
May-10 Letting

Traffic Control MOBILE OPERATION FOR PAVEMENT MARKING MULTI-LANE HIGHWAY

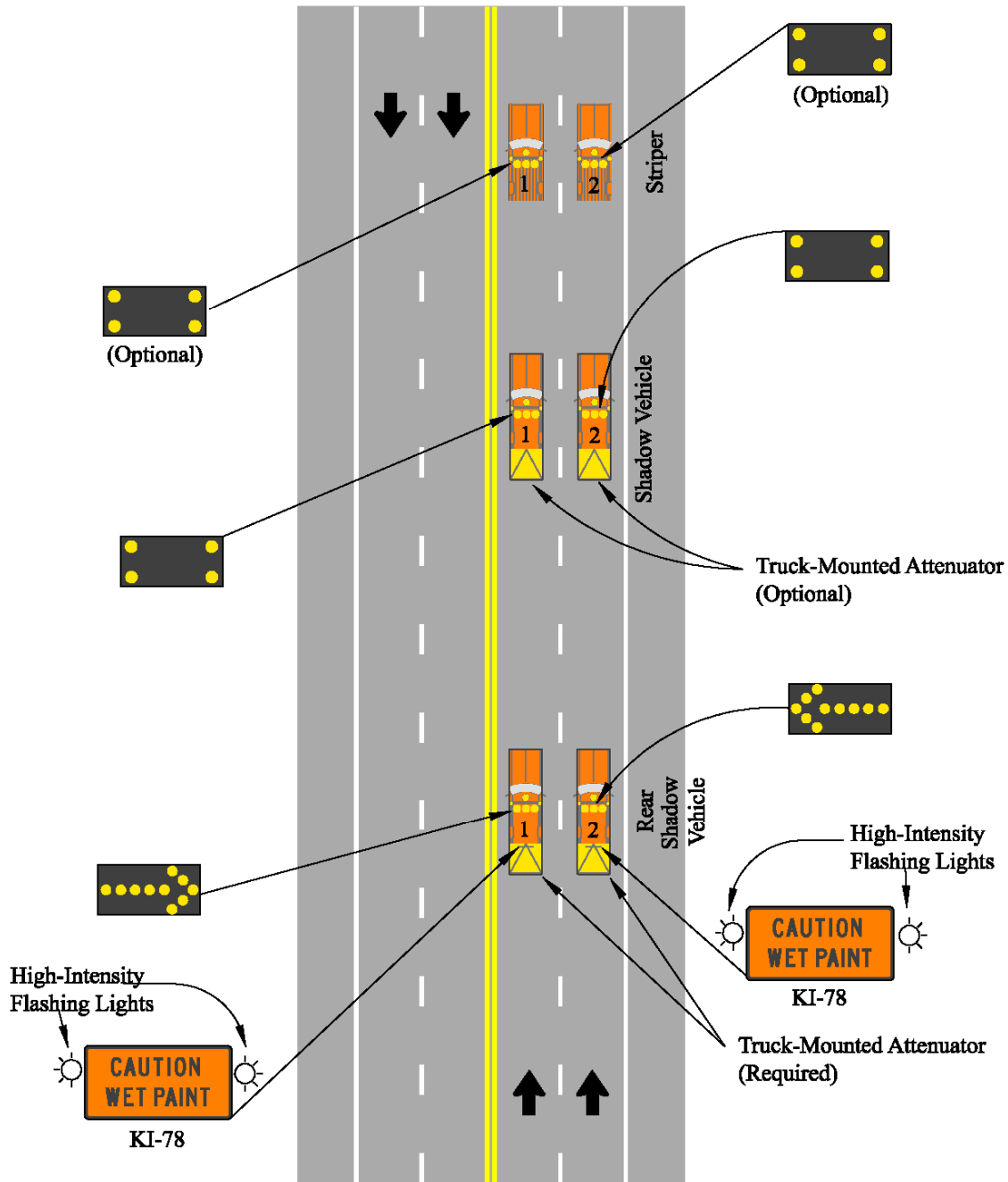

- 1 - Inside Lane Position
Painting of lane lines and left edge lines.
- 2 - Outside Lane Position
Painting of lane lines and right edge lines.