

Northeast District Office
121 S.W. 21st Street
Topeka, KS 66612-1429



phone: 785-296-3881
fax: 785-296-3720
www.ksdot.gov

Calvin Reed, Secretary of Transportation

Laura Kelly, Governor

IMMEDIATE RELEASE

March 6, 2024

For more information:

Kate Craft

Kate.Craft@ks.gov

Demolition work planned on I-470 bridge in Topeka

Demolition of the westbound I-470 bridge in west Topeka is scheduled to take place this weekend, conditions permitting. The work is part of the Kansas Department of Transportation's ongoing bridge replacement project.

Demolition and removal of the existing structure will impact both directions of I-70 in the area between their respective I-470 exit ramps. Motorists should plan for the following:

- **Friday, March 8, at 9 a.m.** – The outside lanes of I-70 will close. Both directions will be reduced to their inside lanes.
- **Friday, March 8, at 7 p.m.** – **I-70 will fully close to all traffic in the work area.**
- **Saturday, March 9, at 3 a.m.** – The inside lanes of both directions of I-70 will open.
- **Saturday, March 9, by 2 p.m.** – I-70 is expected to fully reopen in both directions.

Detours will be marked as follows during the full closure of I-70:

- Eastbound I-70 will be directed to I-470, to KTA/I-470 and back to eastbound I-70.
- Westbound I-70 will be directed to northbound U.S. 75, to westbound U.S. 24, to southbound K-99 in Wamego, and back to westbound I-70.
- Westbound I-470 ramp traffic will be directed east to U.S. 75, then will use the westbound I-70 detour.

Motorists can follow the signed detours or use alternate routes that are not marked. KDOT utilizes state highways for official detour routes for safety, weight and maintenance reasons.

Exit ramps in the area are expected to remain open for the duration of work.

Explosives **will not be used** to demolish the existing bridge. Rather, heavy equipment will be used to break apart and remove the structure. Motorists and spectators are asked to avoid the area, if possible, while demolition work is completed.

On Monday, March 11, at 9 a.m., the inside lanes of I-70 in the work area will close. Both directions will be reduced for approximately four months while the new bridge's center pier is constructed.

KDOT urges all motorists to be alert and obey the warning signs when approaching and driving through a highway work zone. To stay aware of highway construction projects across Kansas, go to www.KanDrive.gov or call 5-1-1.

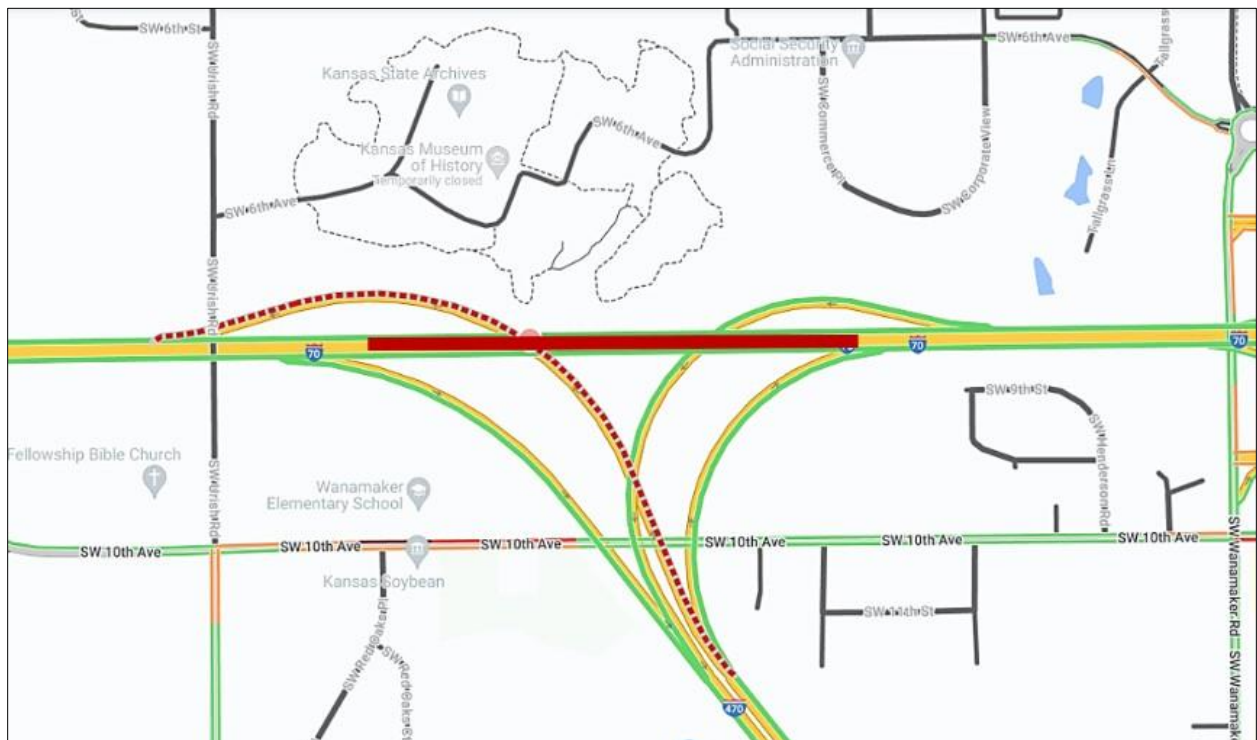

###

This information can be made available in alternative accessible formats upon request. For information about obtaining an alternative format, contact the KDOT Division of Communications, 700 SW Harrison St., 2nd Fl. West, Topeka, KS 66603-3745 or phone 785-296-3585 (Voice)/Hearing Impaired – 711.

Click below to connect to KDOT's Social Networks:

