

Northeast District Office
121 S.W. 21st Street
Topeka, KS 66612-1429



phone: 785-296-3881
fax: 785-296-3720
www.ksdot.org

Julie Lorenz, Secretary

Laura Kelly, Governor

IMMEDIATE RELEASE

Oct. 13, 2022

For more information:

Kate Craft

Kate.Craft@ks.gov

K-4 survey to begin Monday in Wabaunsee County

Beginning Monday, Oct. 17, the Kansas Department of Transportation (KDOT) will conduct a culvert replacement survey over South Bridge Mission Creek on K-4 in Wabaunsee County. The culvert is approximately five miles northeast of the K-4/K-99 junction in Eskridge.

The survey is to gather information that is necessary for the detailed design of the proposed improvement and is estimated to be complete by Dec. 30.

Brian Westburg, P.S., Survey Project Manager, BG Consultants, will oversee this survey for the Kansas Department of Transportation.

A member of the survey crew first will contact property owners and/or tenants for permission to enter private property. Survey activities will include the use of survey instruments on the ground to determine locations of existing features within the survey corridor.

The map below shows the project location.

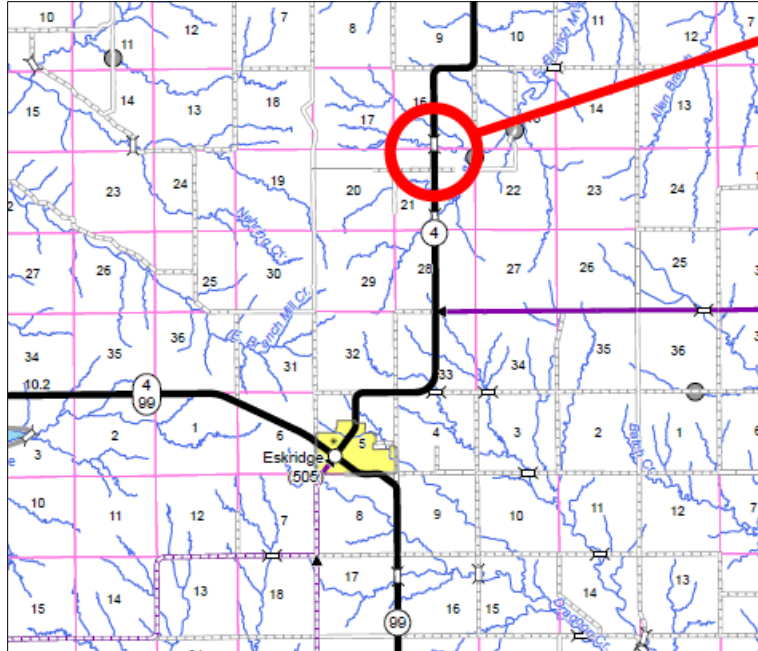

###

This information can be made available in alternative accessible formats upon request. For information about obtaining an alternative format, contact the KDOT Office of Public Affairs, 700 SW Harrison St., 2nd Fl. West, Topeka, KS 66603-3754, or phone 785-296-3585 (Voice) / 7-1-1 (Hearing Impaired).

Click below to connect to KDOT's Social Networks:

