

Northeast District Office  
121 S.W. 21st Street  
Topeka, KS 66612-1429



phone: 785-296-3881  
fax: 785-296-3720  
[www.ksdot.org](http://www.ksdot.org)

Julie Lorenz, Secretary

Laura Kelly, Governor

## **IMMEDIATE RELEASE**

**Nov. 10, 2020**

### **For more information:**

Kelly Kultala  
(785) 207-0715  
[Kelly.Kultala@ks.gov](mailto:Kelly.Kultala@ks.gov)

## **Survey for proposed replacement of Marshall County bridge**

A field survey is expected to begin Monday, Nov. 16 for the proposed replacement of Bridge #035 over Jim Creek in Marshall County.

The proposed replacement is located 4.26 miles north of the of the Pottawatomie County line on K-99.

The survey is to gather information that is necessary for the detailed design of the bridge and expected completion is Feb. 1, 2021.

Johnny Yackle, P.S., Field Survey Project Manager, HDR, will be in charge of this survey for the Kansas Department of Transportation.

A member of the survey crew first will contact property owners and/or tenants for permission to enter private property. Survey activities will include the use of survey instruments on the ground to determine locations of existing features within the survey corridor.

**The map below shows the project location – marked by the red arrow – involved in the survey.**

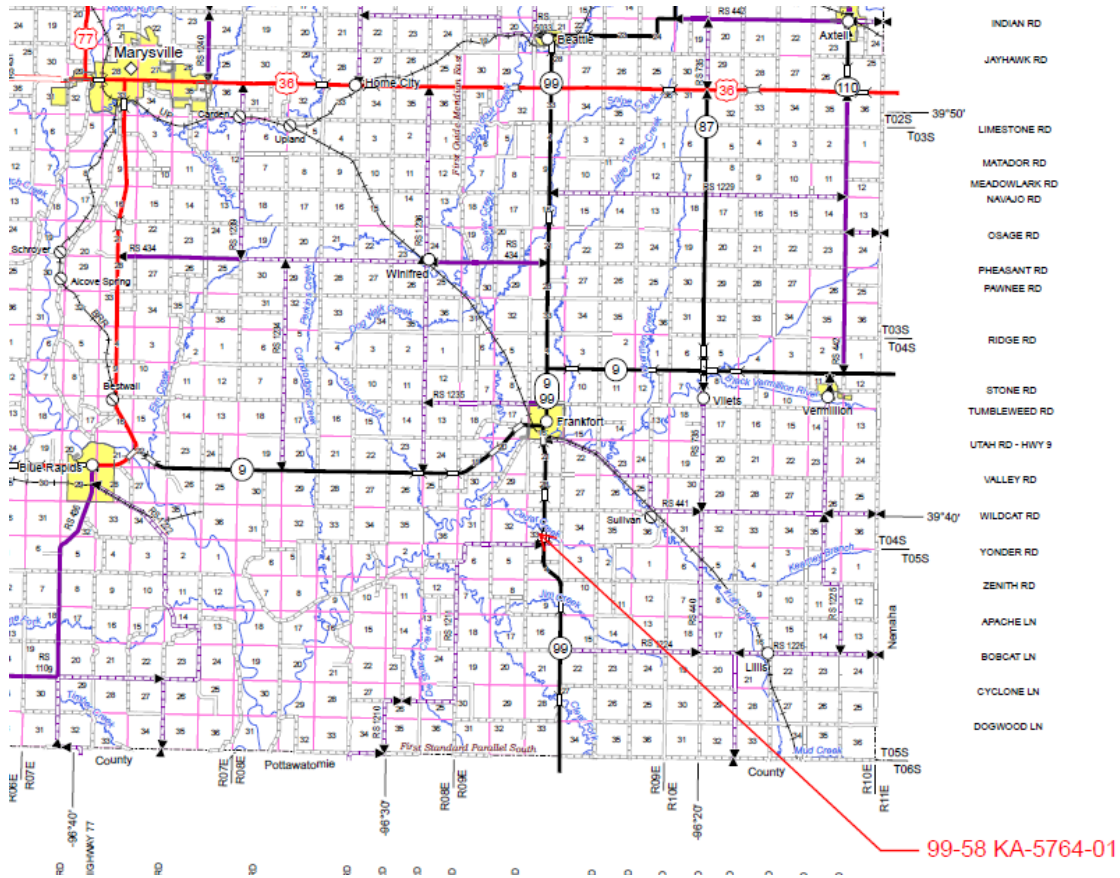

###

This information can be made available in alternative accessible formats upon request. For information about obtaining an alternative format, contact the KDOT Office of Public Affairs, 700 SW Harrison St., 2<sup>nd</sup> Fl West, Topeka, KS 66603-3754 or phone 785-296-3585 (Voice)/Hearing Impaired – 711.

Click below to connect to KDOT's Social Networks:

