

Southeast District Office
411 W. Fourteenth
Chanute, KS 66720-2894



phone: 620-902-6400
fax: 620-431-4406
www.ksdot.org

Julie Lorenz, Secretary

Laura Kelly, Governor

IMMEDIATE RELEASE

Aug. 19, 2020

Contact: Priscilla Petersen, (620) 902-6433; priscilla.petersen@ks.gov

Survey at U.S. 59/169 roundabout starts this week

This week the Kansas Department of Transportation (KDOT) started a field survey for a proposed project to upgrade the roundabout at U.S.59/U.S. 169 junction south of Garnett.

The survey length is 2,000 feet on the existing highway alignment. Activities include the use of survey instruments on the ground to determine locations of existing features within the corridor. A member of the survey crew will contact property owners or tenants for permission to enter private property.

The survey should be completed by October. Sam Walton of Trekk will manage this survey for KDOT. Persons with questions may contact KDOT Public Affairs Manager Priscilla Petersen, (620) 902-6433.

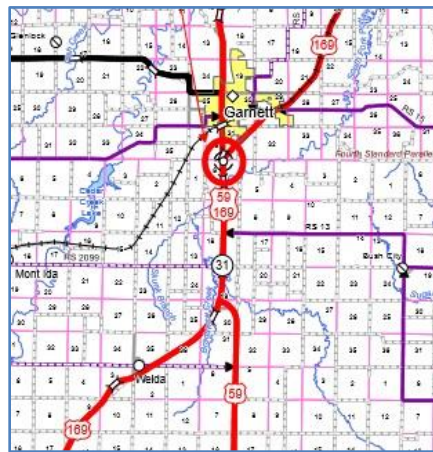

#####

This information can be made available in alternative accessible formats upon request.

For information about obtaining an alternative format, contact the KDOT Division of Communications, 700 SW Harrison St., 2nd Fl West, Topeka, KS 66603-3754, or phone 785-296-3585 (Voice)/Hearing Impaired – 711.

Click below to connect to KDOT's Social Networks:

