

Southeast District Office
411 W. Fourteenth
Chanute, KS 66720-2894



phone: 620-902-6400
fax: 620-431-4406
www.ksdot.org

Julie Lorenz, Secretary

Laura Kelly, Governor

IMMEDIATE RELEASE

April 15, 2021

Contact: Priscilla Petersen, (620) 902-6433; priscilla.petersen@ks.gov

Survey at K-58 bridge starts April 26

The Kansas Department of Transportation (KDOT) plans to begin a field survey at the K-58 bridge over Crooked Creek on Monday, April 26. The bridge is almost seven miles east of the south U.S. 75/K-58 junction and is east of LeRoy.

The length of the survey is 2,600 feet on the existing highway alignment. Survey crew members will gather information for the detailed design of a proposed improvement to replace the bridge. No commitment to construction has been made.

KDOT expects the survey to be complete by May 18. Activities include the use of survey instruments on the ground to determine locations of existing features within the corridor. A member of the survey crew will contact property owners or tenants for permission to enter private property. KDOT Field Survey Project Manager Joe Bowen will manage the survey. Persons with questions may contact KDOT Public Affairs Manager Priscilla Petersen, (620) 902-6433.

Survey area outlined

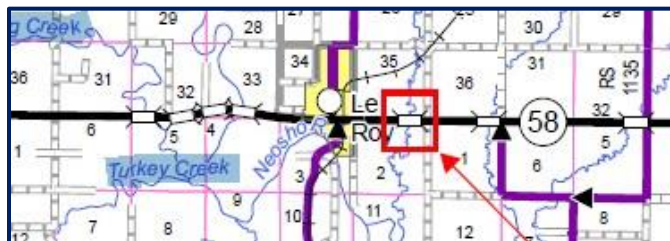

###

This information can be made available in alternative accessible formats upon request.

For information about obtaining an alternative format, contact the KDOT Division of Communications, 700 SW Harrison St., 2nd Fl West, Topeka, KS 66603-3754 or phone 785-296-3585 (Voice)/Hearing Impaired – 711.

Click below to connect to KDOT's Social Networks:

